

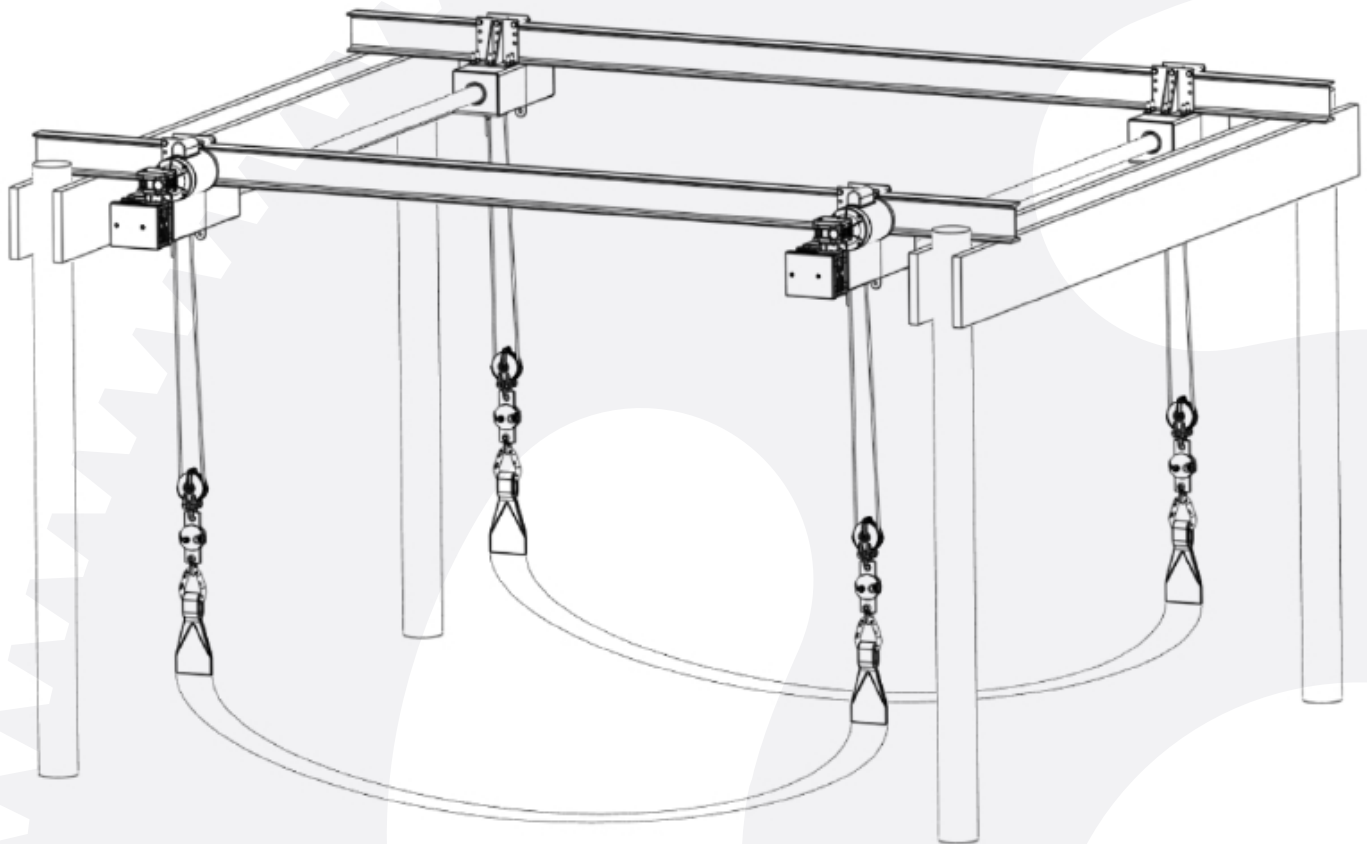

BH-USA

EVERYTHING FOR YOUR DOCK & PIER



THE MAX HEAVY DUTY 16,000 LB OVERHEAD BOAT LIFT INSTALLATION & USAGE MANUAL

FOR BOATS NO MORE THAN 34FT LONG

15286PR RVSD 10/2018

WWW.BH-USA.COM
800-259-8715

KEEP FOR YOUR RECORDS



BH-USA THE MAX HEAVY DUTY BOAT LIFT



BH-USA

— THE MAX —

- ▶ **Made in the USA**
- ▶ **Belt-Less Drives**
- ▶ **Engineered**
- ▶ **Heavy Duty**

BH-USA has been manufacturing boat lifts and hoists since **1979** in Longview, Texas. As one of the nations oldest and most trusted hoist and lift manufacturers, we know that your selection of the **THE MAX Heavy Duty Boat Lift** is the **right choice**. **THE MAX** is the strongest and most well built overhead lift available. It's engineered and designed for **HEAVY** use and **low maintenance**.

▶ BEFORE YOU BEGIN

The BH-USA Max overhead lift is intended to be mounted on top of wood or steel stringers which attach to pilings. The stringers and pilings must be able to carry the load of the lift and boat to be lifted. BH-USA used **8" pilings** with double **2 x 12" stringers** for engineering and testing. The BH-USA Coastal Series Lifts have the option of HD galvanized steel overhead beams, if not provided by your builder. Pilings and Stringers are the responsibility of the builder or customer. (*Consult your local boat house builder for recommended minimum pile sizes and stringer sizes*). If providing your own over-head beams they must not be more than **14ft** outside to outside. Using longer beams will effect the overall rating. For the **16K** rating use **6" steel 12.5 # AS I-beams**.

▶ SHIPPING

THE MAX overhead lifts ship complete on a single **14ft x 4ft wood pallet** that is heat shrink wrapped. All lifts ship freight and will be the customers responsibility to unload from truck. Before you sign for the lift, insure the blue heat shrink wrap has not been broken or torn and that the BH-USA part number label with UPC code is still present. Thus insuring all items needed for your installation are present. Each item for each lift is listed on **pg. 7** as a reference.

▶ LIFTS COVERED IN THIS GUIDE

- ▶ *16,000 lb MAX drive lifts*
- ▶ *16,000 lb MAX drive lifts w/ optional overhead beams*

All lifts come standard with **galvanized drive pipes** and **polyester weighted slings** rated at **12,000 lbs each**.

SETTING UP BEAMS AND BRACKETS

▶ STEP 1: SETTING UP BEAMS AND BRACKETS

Install Optional Beams and Brackets as shown

Optional Beams come 14 long

Pipes are pre-drilled for 10ft space between beams

6" 12.5 lb Structural Steel beam both standard and wide flange

NOTE: Insert the cable winders while sliding the pipe through the max drive units before setting the drive pipe or you will have to un-install!

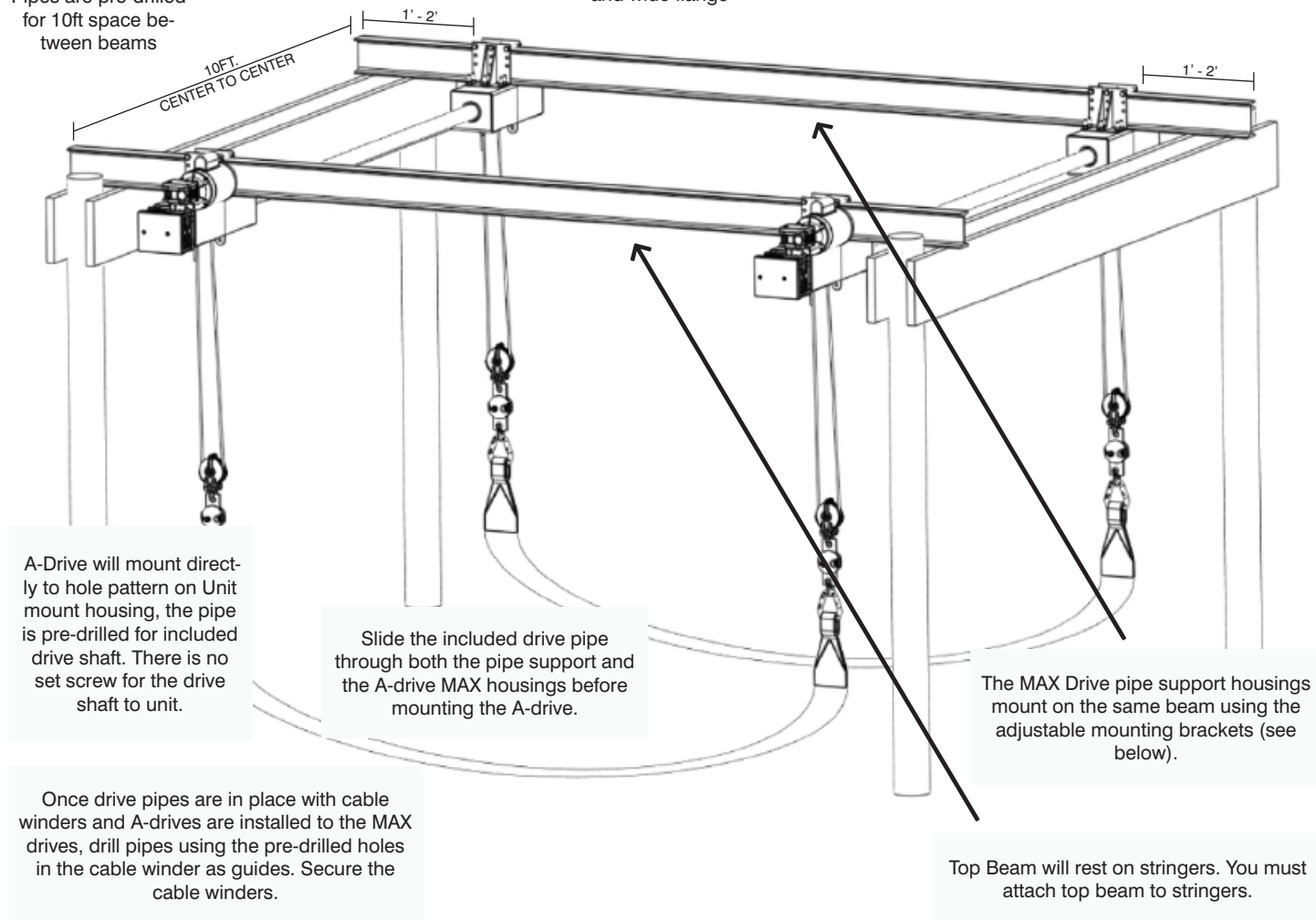

A-Drive will mount directly to hole pattern on Unit mount housing, the pipe is pre-drilled for included drive shaft. There is no set screw for the drive shaft to unit.

Slide the included drive pipe through both the pipe support and the A-drive MAX housings before mounting the A-drive.

The MAX Drive pipe support housings mount on the same beam using the adjustable mounting brackets (see below).

Once drive pipes are in place with cable winders and A-drives are installed to the MAX drives, drill pipes using the pre-drilled holes in the cable winder as guides. Secure the cable winders.

Top Beam will rest on stringers. You must attach top beam to stringers.

When connecting the front and back MAX drives with the drive pipe, insure the two Max drives are lined up perfectly and plumb with each other. The pipe should slid through all 4 bearings with ease. If the pipe is not straight and putting pressure on a bearing, the bearing could fail under load!

- ✘ Do **NOT** attempt to mount MAX any more than 24" in from where structural beam rest on stress stringers.
- ✘ Do **NOT** use any more than a 14 ft. 6" 12.5 lb. Structural beam and place the max drive close to stringers for optimal strength.
- ✘ **NO alterations** should be made to this lift.
- ✘ Top beams should **NOT** be placed any further than 10ft apart, placing beams further apart will effect overall rating.
- ✓ Pipe must be straight, plum and easily turned by hand when installed between the two brackets.
- ✓ Don't forget to insert cable winder before you slide pipe in!
- ✓ Pipe is pre-drilled for hoist but might have to be drilled for cable.



THE MAX DRIVE

▶ STEP 2: INSTALL PILLOW BLOCK IN MAX HOUSINGS

BOX 84871 KIT 84872

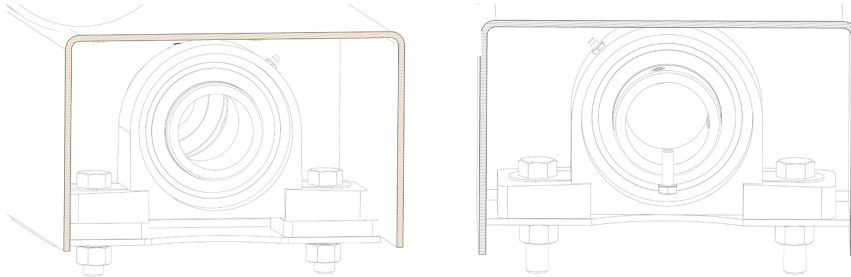

TOP VIEW

- ▶ PRE-GREASE PILLOW BLOCK TO INSURE IT TURNS SMOOTHLY.
- ▶ SET SCREW SIDE OF PILLOW BLOCK MUST BE INSTALLED ON OUTSIDE OF CABLE
- * BOLT THE PILLOW BLOCKS INSIDE THE MAX HOUSINGS

▶ WARNING

Proper Pillow Block installation and cable winder is crucial, failure to follow this guide could result in bearing failure

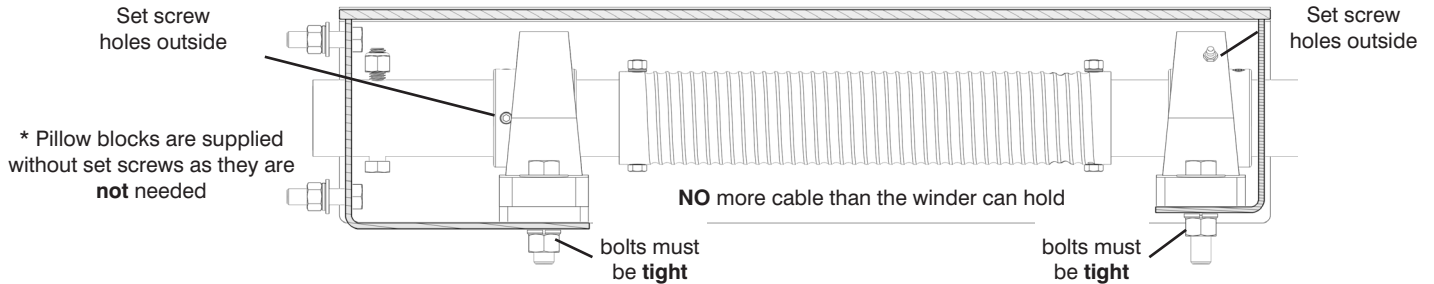

* Cable can **NOT** wrap past the winder, if cable is able to "bunch" against bearing it can breach the bearing sleeve



▶ MOUNTING THE MAX DRIVE

BOX 84871 KIT 84873

Mount Max to beam before mounting A-Drive and Electric Motors.



HEAVY 75LBS.

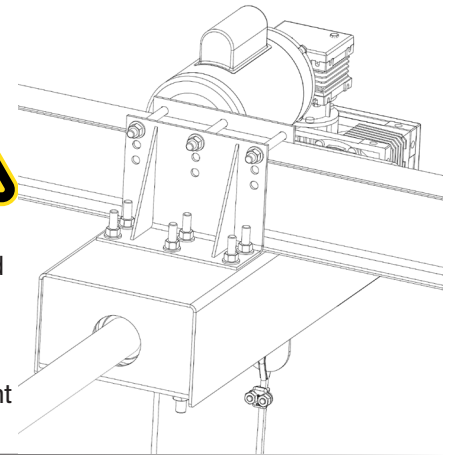

The MAX Drive adjustable mounting plates are designed to fit an American Standard I-Beam or an American Standard wide flange beam of to **4"** wide. The MAX Drive "clamps" around the beam using hardened bolts supplied by BH-USA.

WARNING: The MAX Drive is extremely heavy (weight 75LBS) do not attempt to mount by a single person.

▶ MOUNTING THE A-DRIVE TO THE MAX

The Max Drive pipe housing unit mount will have a flange mount pattern on the end of the housing. The flange mount on the A-Drive will easily match the housing. Mount the A-Drive with the motor reducer in the *12 o'clock position* so the motor will sit on-top of the Max Drive. Mount the A-Drive without motor to the installed MAX Drive. Be sure to insert the drive shaft into the pipe. There is no set screw attaching the drive shaft to the A-drive sleeve. All bolts must be used when mounting the A-drive!

Drive shaft bolt pack **84880**

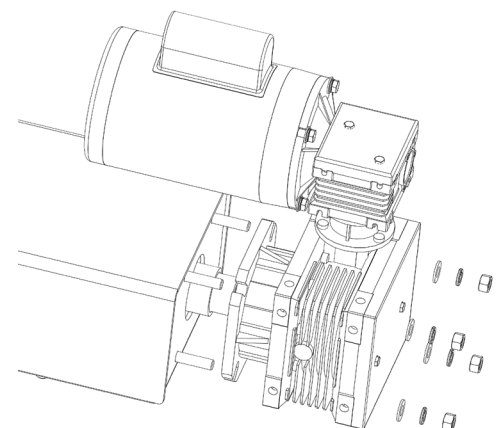

▶ CABLE WINDERS

Install cable winders on drive pipe before attaching a-drive

*MUST USE TWO BOLTS PER WINDER

BOX 84871 KIT 15042

✓ The MAX drive pipe and motor mounts are designed to work with each other with one piece of pipe.

✗ NEVER attempt to use the Max unit mount drive by itself lifting the boat with a short piece of pipe.

ATTACHING THE CABLE TO THE MAX

▶ STEP 3: ATTACHING THE CABLE TO THE MAX

BOX 84871 KIT 12220 & 84818

The Max lift comes with pre-drilled cable holes that are 10ft apart and pre-drilled cable winder holes - if you need to drill please see step 1

1. Using the cable winders, drill a larger than **5/16"** hole for the cable to attach to the drive pipe, the cable winder has a large hole at one end for this purpose. Drill two smaller holes for the stainless steel bolts attaching the cable winder to the drive pipe.
2. The end of the cable should then be passed through the pipe and secured with a cable stop or clamp. Use the 1/4" clamp in kit #70118 for stop

During the operation of the lift, always insure that there is at least one wrap on the drive pipe. The cable stop **WILL NOT** hold the boat.

Max drive comes with 4 pieces of pre-cut 5/16" cable at 50ft. long. Depending on application you may or may not need to cut the cable. **NEVER** let cable over spool on cable spool.

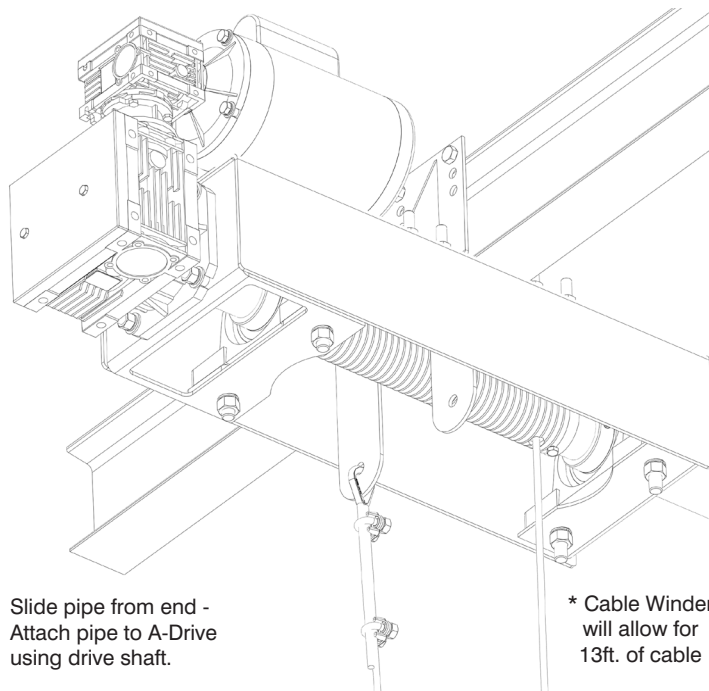

INSTALLING MAX LIFT CABLE

The cable supplied with the max lift is **50ft long** - there is a green end

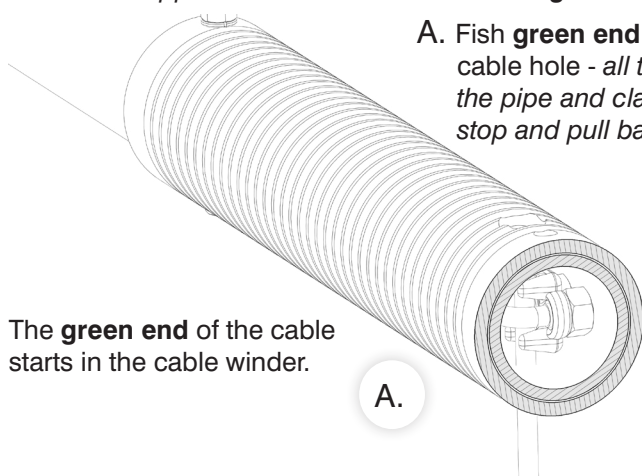

A. Fish **green end** of cable through cable hole - all the way through the pipe and clamp cable as stop and pull back

The **green end** of the cable starts in the cable winder.

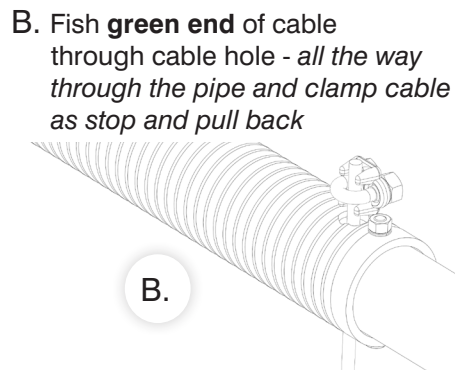

B. Fish **green end** of cable through cable hole - all the way through the pipe and clamp cable as stop and pull back

Run cable to Sling Block then **up** to Dead Man and Clamp Off **Cut left over cable**

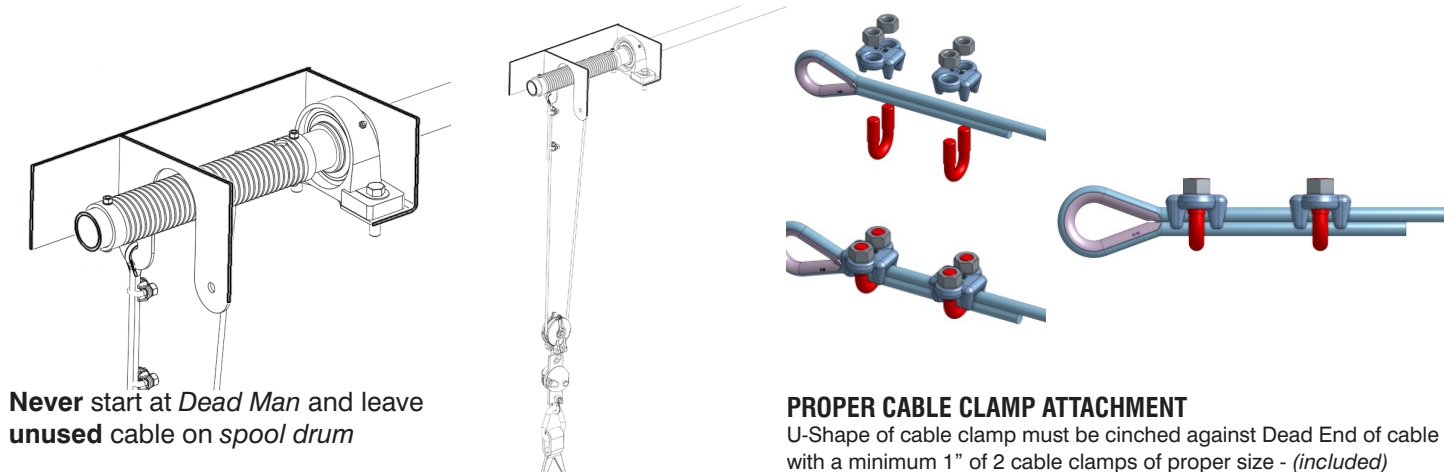

Never start at Dead Man and leave **unused** cable on spool drum

PROPER CABLE CLAMP ATTACHMENT

U-Shape of cable clamp must be cinched against Dead End of cable with a minimum 1" of 2 cable clamps of proper size - (included)



ATTACHING THE CABLE TO THE MAX

EASY MEASURING TIP

The **Red Mark** on your cable is the maximum amount of cable your winder can carry.

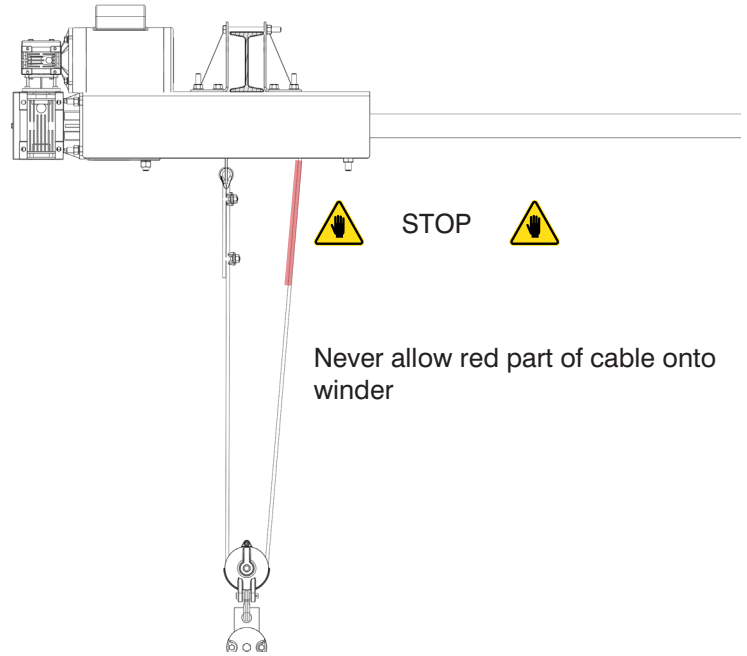
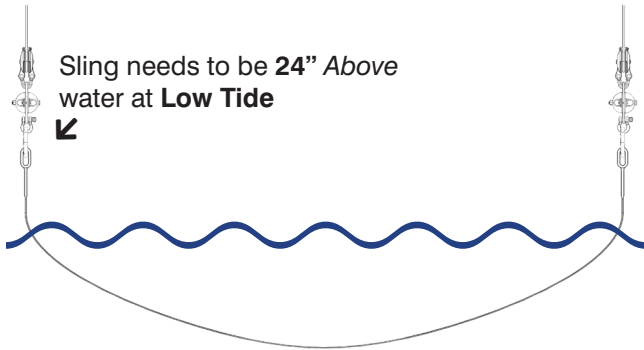

▶ STEP 4: CABLE ROUTING AND DEAD MAN

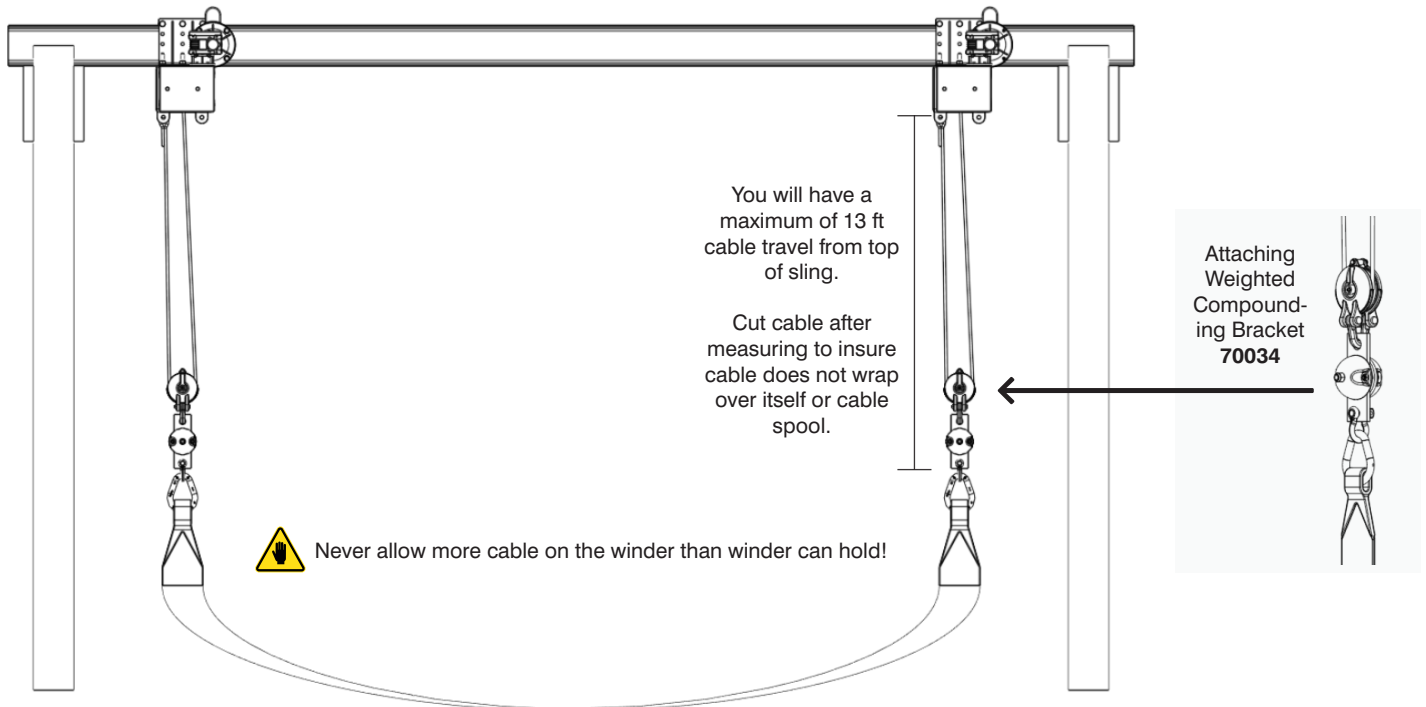

▶ STEP 5: SWITCH MOUNT PLATE

#61412

Use switch mount plate & mount switches together **DO NOT** mount switches where you can reach them from the boat

FAILURE TO NOT USE SWITCHES MOUNT PLATE WILL VOID ALL WARRANTY AND LIABILITY

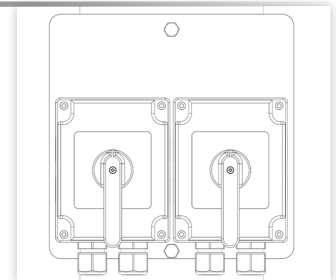

PROPER BOAT PLACEMENT ON SLINGS

Between the slings or cradle beams position the boat so that the center of gravity is before and after to equalize the load on each beam. Failure to do so could overload one of the beams.

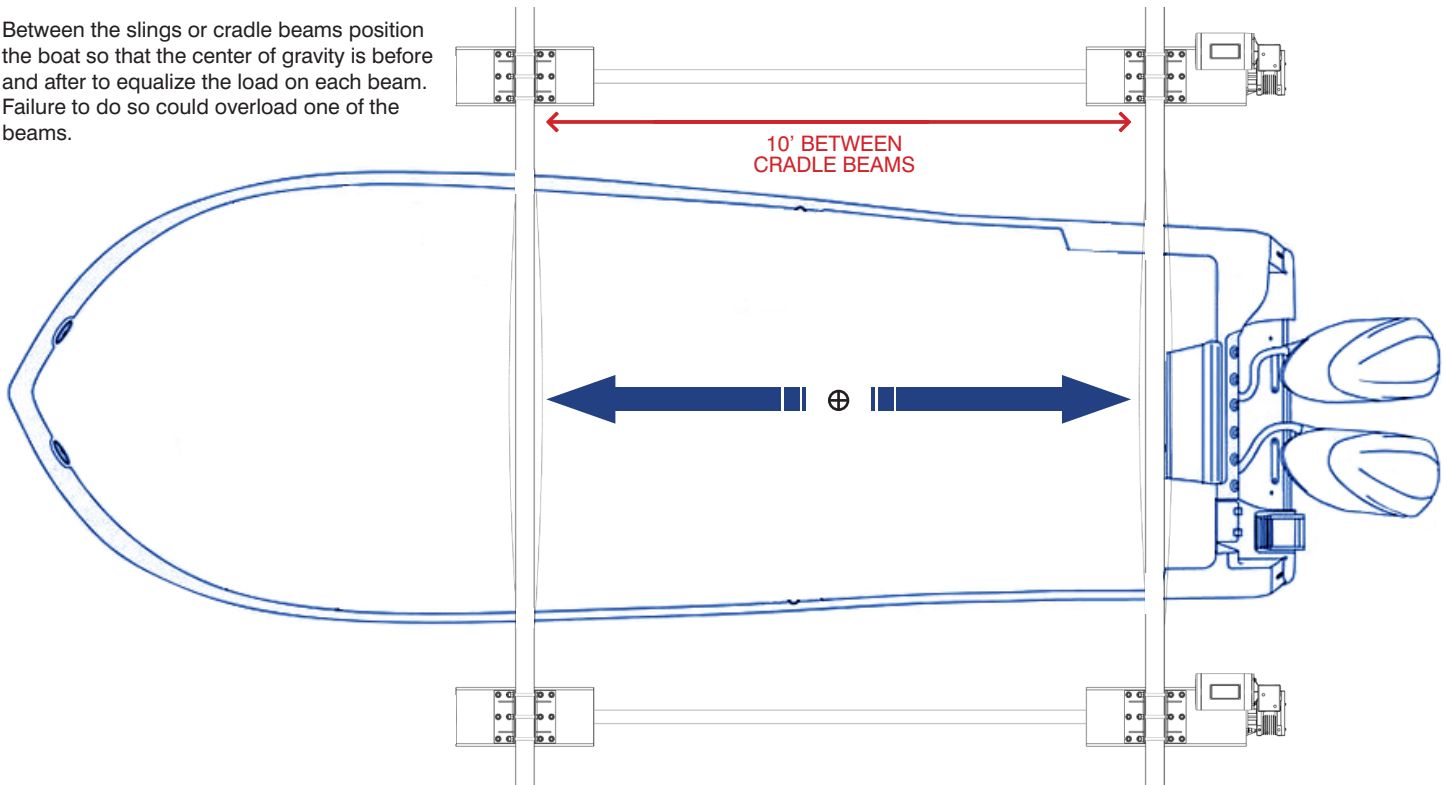

Center the bunks on the cradle beams to equalize the load port and starboard.

The weight of your boat **MUST BE EVENLY DISTRIBUTED** on the slings to ensure your safety and longevity of your lift. Consult the boat manufacture for the center of gravity on your boat.

18 to 24" off transom is general rule of thumb and covers most out-board boats. Your boats center of gravity may be different.

It is the responsibility of the boat owner to know where the center of gravity is on their boat. The center of gravity is where there is equal weight between the slings or cradle beams. For most boats this will be closer to the stern. A general rule of thumb is there should be **no more** than 24" of stern hanging past the rear lift points. The owner is responsible for properly loading their boat on the slings or cradle. Failure to do so could cause the boat to tip or, transfer more load to the back cables causing a cable failure.

NEVER store the boat more than 4ft above the water. This will insure that if there is an equipment failure your boat will safely land in the water and minimize damage.

IT IS THE RESPONSIBILITY OF THE INSTALLER AND OR END USER TO ENSURE:

1. The installation is complete and **no** alterations were made to this lift
2. That **all moving pieces** have been **lubricated**
3. Adequate power is supplied to the lift and **not** using an extension cord or generator
4. **GFCI** has been tested and is working
5. Cable has been inspected and has **no** broken strands and shows **no** signs of distress
6. Cable has been attached properly using proper cable attachment as outlined in this guide
7. Center of gravity of the boat is located by equal deflection of the lift beams or slings.
8. Cable is wrapping on cable winder correctly
9. Switch is permanently mounted and **NOT hanging**, no electrical cords touching water
10. User understands proper operating and to never be in the boat while on lift or swim around lift.



ELECTRICAL REQUIREMENTS

▶ BOAT LIFT ELECTRICAL REQUIREMENTS

Supplying the proper electrical service to your boat lift is required for the lift to operate correctly. Inadequate service will keep the lift from lifting its maximum load and will damage your motor. Your MAX lift has been **supplied** with a **pre-wired** and tested **Elite Motors**.

16,000 LB LIFT

1.5 HP ELITE STAINLESS MOTOR 240 VOLT

**20 AMP CIRCUIT
EACH MOTOR**

Each motor comes standard with a lock-on drum switch. The switch has been factory wired and tested. One motor has **16ft** & one motor has **40ft 14/5 wire** from motor to switch and 5 ft GFCI cord from switch to plug.

For more information about the motors and switches including **IP** and **UL ratings**, visit the motors product page at WWW.BH-USA.COM

WIRE REQUIREMENTS THAT ENABLE THE BH-USA HOIST TO OPERATE CORRECTLY WHEN LIFTING STRAIGHT LINE:

WIRE SIZE CHART FOR ELECTRIC MOTORS BASED ON DISTANCE FROM SERVICE TO MOTOR

NUMBER OF MOTORS	HP	AMPS TO RUN 115V	AMPS TO RUN 230V	50 FT AT 115V	50 FT AT 230V	100 FT AT 115V	100 FT AT 230V	200 FT AT 115V	200 FT AT 230V	300 FT AT 115V	300 FT AT 230V	400 FT AT 115V	400 FT AT 230V
1	3/4	10.8	5.4	#14	#14	#10	#14	#8	#12	#6	#12	#4	#10
1	1	12.8	6.4	#12	#14	#10	#14	#6	#12	#4	#12	#4	#10
1	1.5	17.0	8.5	#12	#14	#8	#12	#6	#10	#4	#10	#2	#8
2	3/4	21.6	10.8	#10	#12	#8	#12	#4	#10	#2	#8	XX	#6
2	1	25.6	12.8	#8	#10	#8	#10	#4	#10	#2	#6	XX	#4
2	1.5	34.0	17.0	#8	#10	#6	#10	#2	#8	#0	#4	XX	#2

- ▶ The electric motor on this lift was wired and tested under load at BH-USA.
- ▶ If your motor starts to lift the boat then stops, check your voltage and confirm your wire to the chart above. This is **NOT** a motor issue.
- ▶ If you **un-wire** the BH-USA drum switch and **re-wire** the motor to an existing switch or remote and the motor does not work, check the wiring guides to the manufacture remote or switch you wired too. If in doubt, re-wire the switch you removed the way it was to see if the motor works.
- ▶ If your electrician decides to re-wire any of our equipment and feels like our directions are wrong, they assume all **liability** and **warranty** (follow our directions please)
- ▶ Don't forget to remove the drain plugs on the motor, motors that fill up with water are **NOT** covered under warranty.
- ▶ Using an *extension cord* or *generator* will **damage** the motor and will not be covered under warranty.

▶ SAFETY FIRST!

- ✘ A hoist should **NEVER** be used to lift human beings.
- ✘ **NEVER** use a hoist for any other application, other than the one for which it is designed.
- ✘ **NEVER** put children or adults in a boat while the boat is on a lift.
- ✘ **NEVER** allow children or adults to swim around or under a boat lift, or near the boat lift when it is submerged.
- ✘ **NEVER** stand on a lift platform if partially submerged, due to the possibility of electric shock.
- ✘ **NEVER** mount or hang a drum switch where it can be reached while in the boat.
- ✓ **ALWAYS** exit the boat and have all passengers exit the boat before lifting the boat.
- ✘ **NEVER** ride the lift while in the boat.
- ✓ **ALWAYS** have an operating bilge pump with a functional float switch in any boat on a lift. Rain water can fill the boat adding thousands of pounds that the lift might not be able to handle.

BH-USA supplies a hardened **GR5** bolt with all hoists and A-drives, to attach the drive pipe to the hoist. It is the end-users responsibility to ensure that the installer did use the **GR5** bolt supplied by BH-USA. Using a weaker grade bolt can cause the weaker bolt to fail and drop the boat.

Hoists are **NOT** designed, nor intended to lift human beings, or to lift loads over areas where humans might be. Precautions, such as using **NEMA** and **UL** components and installing **GFCIs** on systems and wiring should not be relied upon when the risk of electrocution is possible.

Components can fail. For this reason it is **NEVER** to swim around a lift. Be vigilant about safety, submerged cables can conduct electricity to the water if your system is not properly grounded, or you have developed a voltage leak.

During the threat of exceptionally bad weather, such as a tropical depression or storm, hurricane or gale force winds, a boat should be removed from the lift and stored on a trailer in a safer place.

Must be 18 years or older to operate Lift and must have fully read and understands the operating instructions.

Before use, review the BH-USA overhead lift guide and BH-USA equipment guide.



ATTENTION MARINA/YACHT CLUB MANAGERS OWNERS & END USERS OF THE MAX LIFT.

▶ KNOW YOUR LIABILITY

your MAX lift is rated for boats no longer than 34 ft and weighing no more than 16,000 lbs when fully loaded. The number one reasons lifts fail are due to not following installation instructions and not educating the end user on proper lift usage.

*It is the responsibility of the Yacht Club or Marina management to educate each user and post the proper **sign at each lift with simple usage instructions.***

▶ LIMIT YOUR LIABILITY

Each user of the MAX lift must have a copy of this installation and usage guide. Mount the switch plates with the warning labels and post the included Aluminum sign at every slip. A training program for proper lift usage should be administered by the marina management before a user can use his lift and a signed and dated copy of the installation and usage guide should be kept on file by the marina.

Please refer to sign on **PG.9**

HOW CAN A LIFT FAIL

Below are the most common reasons a lift fails, these are not every reason

1. TO MUCH CABLE ON PIPE

When cable raps over itself it will push against the bearing and cause the bearing to fail. BH-USA paints a red section on the cable that allows the end user to see when to stop the lift.

2. BOAT NOT PROPERLY SPACED ON SLINGS OR CRADLE

When too much of the back of the boat is hanging off the lift, it transfers load to the back cables and can cause the cables to snap.

3. ALTERING ANYTHING IN THE DESIGN OF THE LIFT

Max lifts are engineered to lift the rating safely as long as nothing is changed by the end user or installer, this include pre set sling spacing and overhead beam spacing. The lifts must be installed exactly to the directions included.

It is the responsibility of the Yacht Club or Marine management to educate each user and post the proper sign at each lift with simple usage instructions.



BOAT LIFT OPERATION

1. POSITION BOAT PROPERLY!

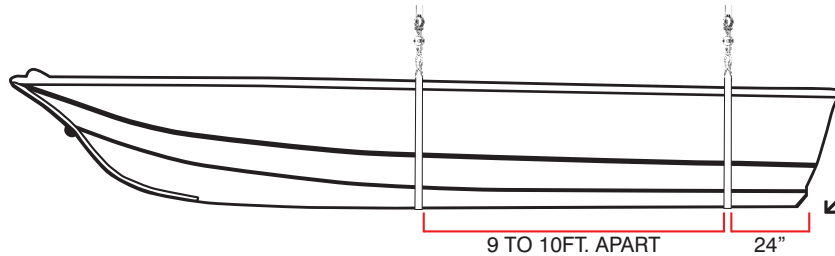

GENERALLY NO MORE THAN 24" OF STERN HANGING PAST THE REAR LIFT POINTS OF THE SLING OR CRADLE

2. DO NOT RAISE BOAT MORE THAN 4FT ABOVE WATER

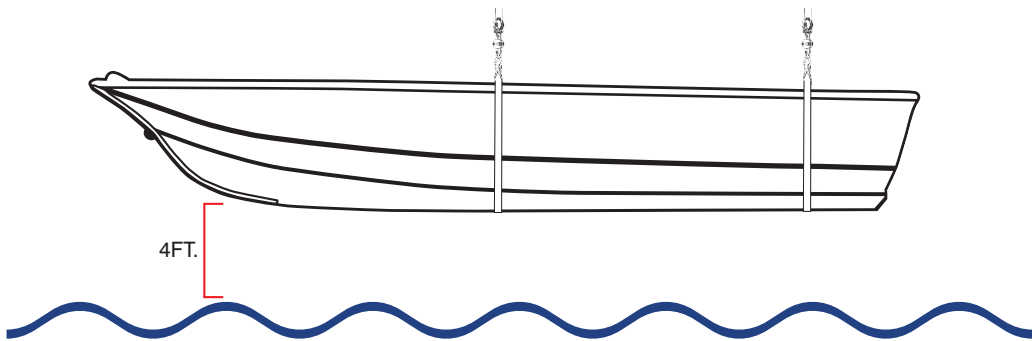

3. STOP LIFT BEFORE RED PART OF CABLE REACHES CABLE SPOOL OR BOAT IS 4FT ABOVE WATER

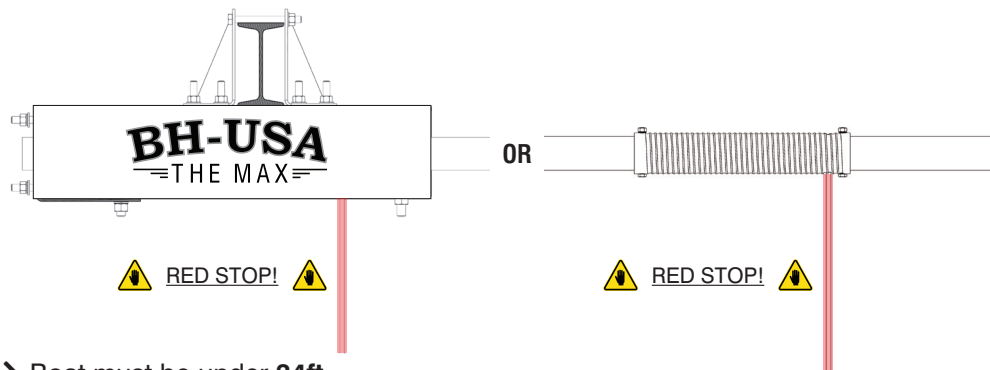

- > Boat must be under **34ft**
- > Boat must be **NO MORE** than lift rating when fully loaded
- > Must be **18** or older to operate
- > **NEVER** stand on the boat or Lift while operating
- > **NEVER** swim around or under a lift
- > Do **NOT** leave boat on Lift During a Major Storm

BH-USA
800.259.8715
WWW.BH-USA.COM





What is covered on your MAX lift:

- 30 Days from purchase date: Switches and GFCI
- 1 year from purchase date: Electric Motors
- 5 years from purchase date: A-Drive Enclosed gear boxes

What is NOT covered under BH-USA warranty and Liability

- Structural Steel Fasteners
- Slings Cable
- MAX housing Drive Pipes
- Pillow Blocks Ball bearing blocks

Any item on the MAX lift that has a mill rating or stamped rating is not covered under any liability or warranty. These items will only fail if not used properly and are free of any defects in manufacturing.

Warranties – The products sold by Boat Hoist USA which are not specifically represented to be manufactured by Boat Hoist USA may be covered against defects by a manufacturers’ warranty. If such warranty is provided, warranty information should be included with your product. Should you experience any product defects outside of our return period or if you have any questions, please call 800-259-8715.

Disclaimer of Warranty – Boat Hoist USA disclaims all warranties either express or implied, including but not limited to implied warranties of MERCHANTABILITY and FITNESS FOR PARTICULAR PURPOSE with respect to any merchandise purchased from a Boat Hoist USA showroom, Online catalog or mail order catalog. Boat Hoist USA’s liability in connection with a customer’s purchase is expressly limited to Boat Hoist USA’s return policy set forth above, and all claims for consequential, incidental, or special damages are hereby excluded.

Replacing Faulty Equipment - Boat Hoist USA will only replace faulty equipment after warranty issue has been claimed and Boat Hoist USA determines the equipment to be faulty. The customer can purchase a replacement piece and be credited once the faulty piece is found to be covered under warranty. If the returned piece is not covered under warranty, the customer will not be credited for new equipment bought and will be subject to Boat Hoist USA’s return policy. The customer will be billed for freight charges in returning the equipment.

Boat Hoist USA Labels – Any tampering with, removal of, or covering any label, serial number or rating label applied to products manufactured by or sold by Boat Hoist USA will void all warranties with no exceptions. Wire Rope and Rigging Due to uncontrolled use and differences in all applications and environments all rigging hardware including but not limited to wire rope/cable, shackles, wire rope clamps and fasteners are not covered under any warranties and Boat Hoist USA cannot be held responsible for any damages both to property or personal cause by rigging hardware breaking or failing.

Labor & Time Lost – Boat Hoist USA is not responsible for any labor or time lost by a company due to faulty equipment, incorrect shipments, lost shipments, backorder or any other mistake that might be caused by Boat Hoist USA or one of the freight companies used.

10. Governing Law – Any dispute arising out of purchase of any merchandise herein, or the use of same, or regarding the collection of any unpaid amounts due, notwithstanding where or how the purchase was made or the product used, shall be governed by and construed under the laws of the State of Texas and venue of such disputes shall be exclusively in Gregg County, Texas

IN NO EVENT SHALL BOAT HOIST USA BE LIABLE FOR ANY DAMAGE OR REFUND IN EXCESS OF THE AMOUNT ACTUALLY PAID BY THE CUSTOMER OF BOAT HOIST USA FOR THE MERCHANDISE IN QUESTION.

BH-USA makes available the easy warranty and returns section on their web-site. If you feel an items has a defect in manufacturing visit www.bh-usa.com and click on the easy returns tab to start the warranty process

MAX LIFT PACKING GUIDE

WHILE UN-PACKING LIFT PLEASE CHECK OFF EACH ITEM, BOXES WILL BE LABELED WITH THIS DESCRIPTION AND PART NUMBER

ITEM	DESCRIPTION	QUANTITY	LIFT NUMBERS	✓
15285	Max Lift with A-Drive Mount	2	All Lifts	
15284	Max Lift Pipe Hanger (no A-Drive Mount)	2	All Lifts	
70035	2 7/16" Pillow Blocks	8	All Lifts	
15284FA	Max Lift Hanger "L" Bracket	8	All Lifts	
70148	Cable Winder Boat Lift Style for 2 2/38" Pipe	4	All Lifts	
07295	7K A-Drive Shaft to 2" Pipe	2	All Lifts	
02158	3TON Blocks (4 blocks in box)	1	All Lifts	
93104	Elite Stainless Steel 1.5HP Motor with 16ft control and switch pre-wired	1	All Lifts	
93104-40	Elite Stainless Steel 1.5HP Motor with 40ft control and switch pre-wired	1	All Lifts	
04777	7k A-DRIVE gear box 40:90 double reducer	2	All Lifts	
70034	Weighted Compounding Bracket	4	All Lifts	
15282	MAX lift drive pipe pre-drilled 2 3/8" OD 2" ID galvanized cut 13.5"	2	All Lifts	
61412	Double switch mount plate with MAX 16K rating stamp	1	All Lifts	
84871	16K Max Lift Hardware Kit	1	All Lifts	
84872	Max Lift Pillow Block Faster Kit (located in kit 84871)	1	All Lifts	
84880	Max Lift A-Drive Shaft Bolt Pack (located in kit 84871)	1	All Lifts	
84818	Pre-Cut Stainless Steel 7 x 19 5/16" Cable 50ft section (located in kit 84871)	4	All Lifts	
15042	Aluminum Overhead Lift Cable Winder Fastener Pack (located in kit 84871)	2	All Lifts	
70118	Wire Rope Clip, Stainless Steel 1/4" Malleable (located in kit 84871)	2	All Lifts	
12220	Wire Rope Clip & Thimble Pack 5/16" Stainless Steel (Located in kit 84871)	1	All Lifts	
79699	6" x 14ft Polyester Black Boat Lift Sling	2	15288, 15291	
84200	6" x 16ft Polyester Black Boat Lift Sling	2	15286, 15290	
84201	6" x 18ft Polyester Black Boat Lift Sling	2	15289, 15292	
84207	8" x 14ft Polyester Black Boat Lift Sling	2	42393, 42409	
84208	8" x 16ft Polyester Black Boat Lift Sling	2	77195, 77196	
84209	8" x 18ft Polyester Black Boat Lift Sling	2	77197, 77198	
73224	Overhead Structural Beams 6" 12.5lb/ft standard flange HDG cut 14ft	2	15291, 15290 15292, 61419	

A BREAK DOWN OF EACH HARDWARE KIT BELOW IS LISTED ABOVE

HARDWARE KIT # 84871			
ITEM	DESCRIPTION	QUANTITY	✓
84872	Max Lift Pillow Block Fastener Kit	1	
84873	Max Lift Clamp Fastener Kit	1	
84880	Max Lift A-Drive Shaft Bolt Pack	1	
84818	Pre-Cut Stainless Steel 7 x 19 5/16" Cable 50ft section	4	
15042	Aluminum Overhead Lift Cable Winder Fastener Pack	2	
70118	Wire Rope Clip, Stainless Steel 1/4" Malleable	4	
12220	Wire Rope Clip & Thimble Pack 5/16" Stainless Steel	1	

HARDWARE KIT # 84872 PILLOW BLOCK FASTENER			
ITEM	DESCRIPTION	QUANTITY	✓
82085FA	5/8" x 3" Stainless Steel bolt	16	
82087FA	5/8" Stainless Steel Flat Washer	32	
82086FA	5/8" Stainless steel Nut	16	
15283	Allan Wrench	1	
82102FA	5/8" Stainless Steel Lock Washer	16	

HARDWARE KIT # 84873 CLAMP FASTENER KIT			
ITEM	DESCRIPTION	QUANTITY	✓
82100FA	1/2" bolt x 5 1/2" Stainless Steel	12	
82124FA	1/2" x 1 1/2" Stainless TYPE 304 Hex Head Bolt	56	
82047FA	1/2" Stainless Steel Nut	68	
82090FA	1/2" Stainless Flat Washer	60	
82048FA	1/2" Stainless Steel Lock Washer	68	

HARDWARE KIT # 84880 A-DRIVE SHAFT BOLTS			
ITEM	DESCRIPTION	QUANTITY	✓
82132FA	1/2" x 3 1/2" zinc plated GR5 HARD bolt	2	
82012FA	1/2" Nylock nut	2	

HARDWARE KIT # 15042 CABLE WINDER FASTENER KIT			
ITEM	DESCRIPTION	QUANTITY	✓
82002FA	5/16" Stainless Steel nut	4	
82003FA	5/16" Stainless Steel Lock Washer	4	
82078FA	5/16" Stainless Steel Hex Head Bolt	4	

HARDWARE KIT # 12220 CABLE WINDER FASTENER KIT			
ITEM	DESCRIPTION	QUANTITY	✓
70124	Wire Rope Clip, Stainless Steel 5/16" Malleable	8	
70145	Cable Thimble Stainless Steel 5/16"	4	

THIS LIFT WAS BUILT
AND PACKAGED ON

DATE: _____

QUALITY CONTROL WAS
CHECKED BY

NAME: _____

LIFT PART NUMBER:

ACCESS MORE INFORMATION AND ORDER ONLINE AT BH-USA.COM

WAYS TO SHOP!



Shop By Catalog
Request Yours
Online or by Phone



Call **800.259.8715**
to Order or Request
A **FREE** Catalog



Shop Our Site
WWW.BH-USA.COM

STAY CONNECTED!



CONTACT US!

 800-259-8715

Monday - Friday
8 AM TO 5 PM CST

STAY CONNECTED!



FOR MARINA OR YACHT CLUB FILE

SLIP # _____

MEMBER # _____

MEMBER NAME _____

SIGNATURE _____

DATE _____

BY SIGNING THE ABOVE I AGREE THAT I HAVE BEEN TRAINED IN LIFT USAGE AND HAVE READ AND UNDERSTAND THIS GUIDE.